

Santa Ana River
Mainstem:
Alcoa Aluminum
Plant Dike

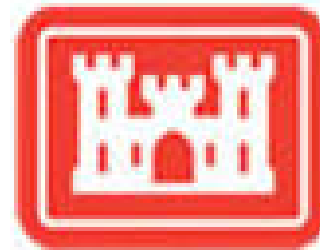

US Army Corps
of Engineers®

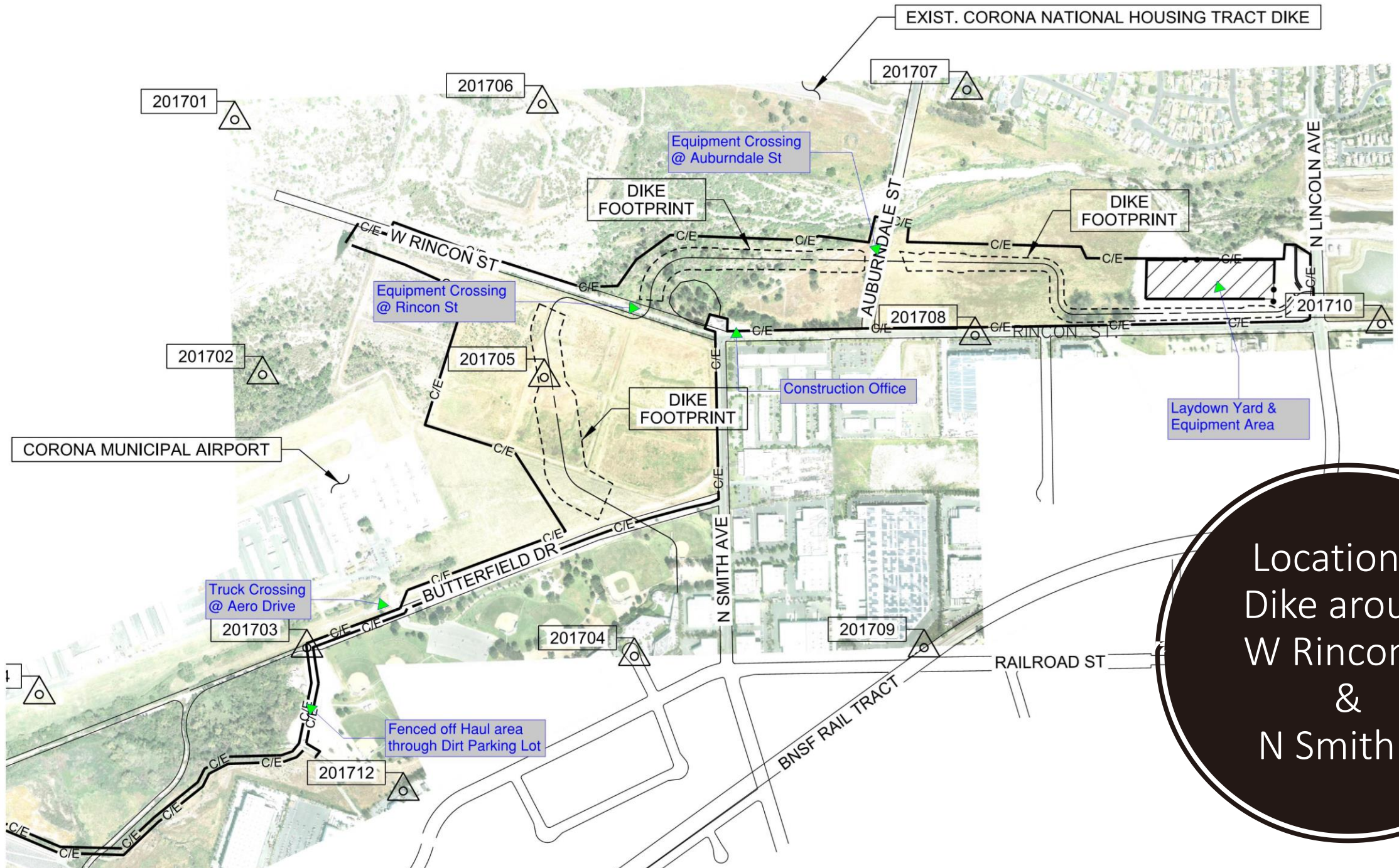



EXIST. CORONA NATIONAL HOUSING TRACT DIKE

201701

201706

201707

Equipment Crossing @ Auburndale St

DIKE FOOTPRINT

DIKE FOOTPRINT

Equipment Crossing @ Rincon St

201702

201705

DIKE FOOTPRINT

Construction Office

Laydown Yard & Equipment Area

CORONA MUNICIPAL AIRPORT

Truck Crossing @ Aero Drive

201703

201704

201709

Fenced off Haul area through Dirt Parking Lot

201712

Location of Dike around W Rincon St & N Smith St

Cross Section of a typical section of dike

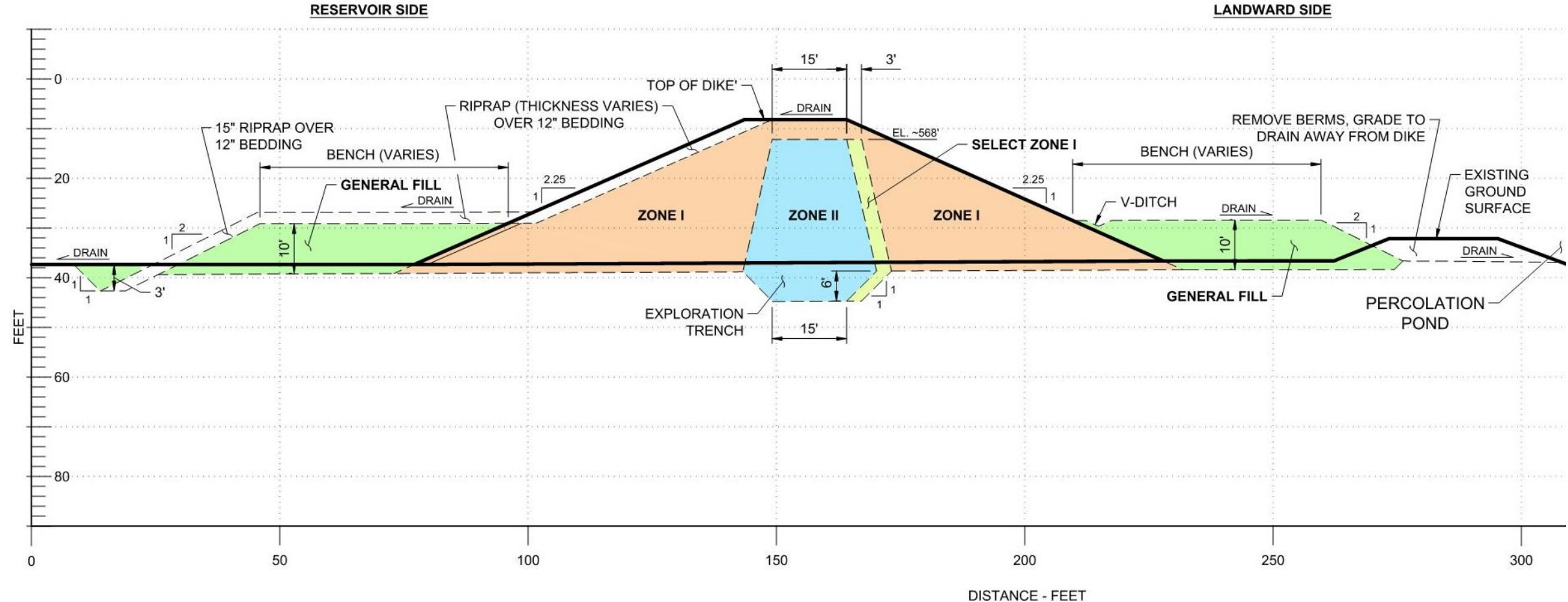

Safety

- Safety is the Number 1 Concern
- Fencing around much of the site to separate construction from public areas
- Utilize all safety standards from OSHA, CalOSHA, USACE, and best practices.
- On-Site Health and Safety Officer
- Maintain barricades and patrol construction site areas.



Traffic

- Traffic mainly to consist of semi-trucks & occasionally heavy construction equipment
- Traffic Control flaggers to help manage traffic flow
- Equipment and Truck Crossings on: Aviation Dr, Rincon St, & Auburndale St
- Heavy haul traffic through the dirt parking lot for Butterfield Park.



Environmental Protection

- Environmental Manager On-site
- Sound wall to protect the habitat of nesting birds
- Best practices for storage and service of equipment and materials
- Containment & Protection of Stormwater
- Air Quality protection from dust and noise



Job by the Numbers

A continuous earthen dike to be built totaling over 2/3 of a mile long and 20ft-40 ft in height

~1,000,000 cy of dirt to be moved in total.

This is 83,000 truck Loads.

As of March 2023, 380,000 cy remain

During peak periods this is ~350 truck trips/day

Detour work complete by September 2023

Santa Ana River Trail Phase 4 (Construction Complete)

Anticipated completion early Spring 2024



PROJECT BROAD VIEW: PRADO BASIN PROJECT FEATURES

Prado Basin Projects

- Completed Construction
- Future Construction
- FY21 CONTRACT AWARDS

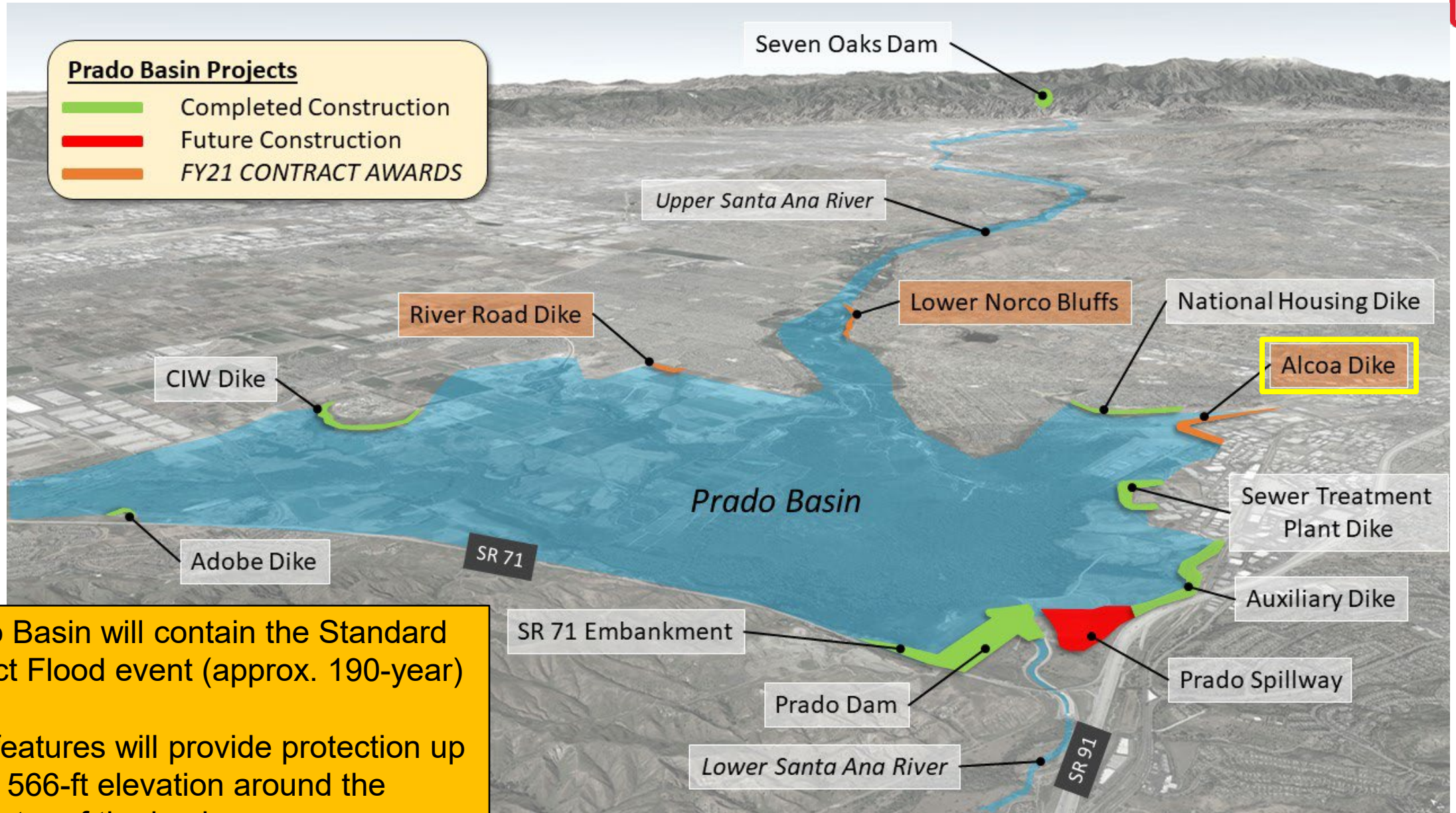

Prado Basin will contain the Standard Project Flood event (approx. 190-year)

Dike features will provide protection up to the 566-ft elevation around the perimeter of the basin