

- LEGEND**
- [E] EXISTING TO REMAIN
  - [S] SIGNALIZED INTERSECTION
  - [CS] REMOVE CONFLICT STRIPING AS NOTED
  - [#] INSTALL CALTRANS STRIPING DETAIL PER NUMBER NOTED, INCLUDING INSTALL OF RAISED PAVEMENT MARKERS
  - [PM] INSTALL PAVEMENT MARKING OR ARROW AS NOTED
  - [GS] INSTALL CHARTREUSE BIKE SHARROW MARKING AS NOTED. SEE DETAIL F AND TRAFFIC STRIPING AND SIGNING NOTES FOR SPECIFICATIONS
  - [CW] INSTALL 12" WHITE CROSSWALK PER CALTRANS STANDARD PLAN NO. A24F, OR AS NOTED
  - [LL] INSTALL 12" WHITE LIMIT LINE PER CALTRANS STANDARD PLAN NO. A24F, OR AS NOTED
  - XX' PROPOSED LANE WIDTH
  - (XX') EXISTING LANE WIDTH
  - △ TRANSITION POINT
  - [IS] FURNISH AND INSTALL TRAFFIC SIGN(S) AS NOTED ON EXISTING STREET LIGHT POLE PER CORONA STANDARD PLAN NO. 518
  - [IP] FURNISH AND INSTALL TRAFFIC SIGN(S) AS NOTED ON NEW POST PER CORONA STANDARD PLAN NO. 519
  - [EP] FURNISH AND INSTALL TRAFFIC SIGN(S) AS NOTED ON EXISTING POST PER CALTRANS STANDARD PLAN NO. R56
  - [RS] REMOVE AND SALVAGE SIGN(S) AS NOTED

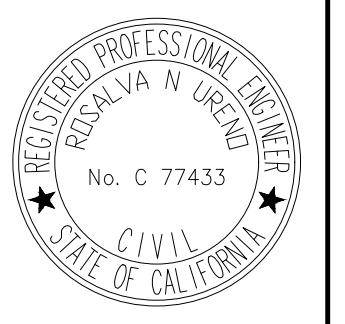
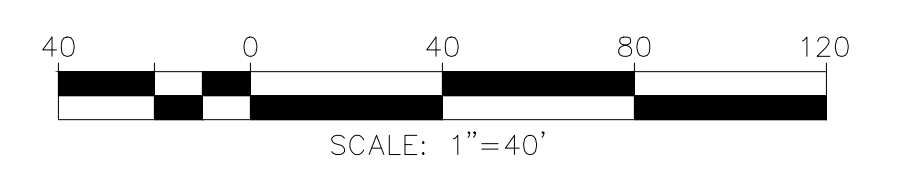
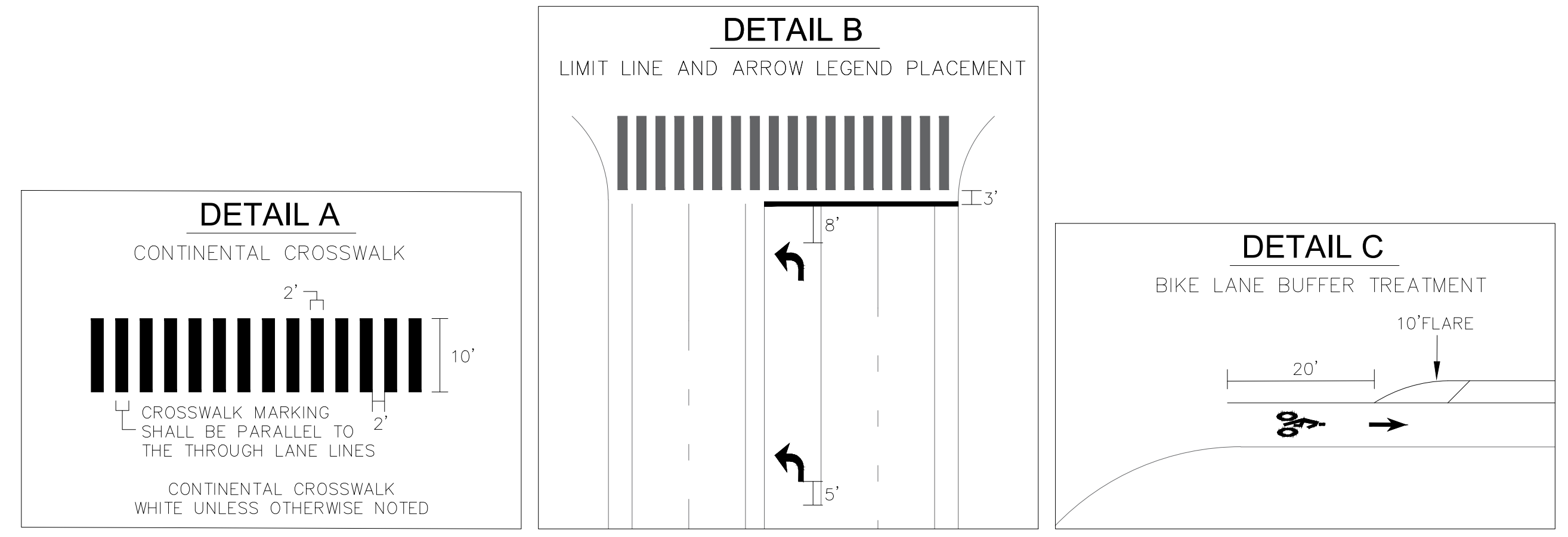

PLANS PREPARED UNDER SUPERVISION OF: DATE ROSALVA N URENO R.C.E. NO. C 77433	DESIGNED BY: AMC	BENCHMARK:	1	APPROVED FOR CONSTRUCTION: DATE	
	DRAWN BY: DT		2		
	CHECKED BY: RNU		3		
REFERENCES	NO.	DATE	REVISIONS	ENGR. APP'D. DATE	ENGINEER

**CITY OF CORONA**  
**SIGNING AND STRIPING - LINCOLN AVE**  
**PAVEMENT REHABILITATION PROJECT**

DRAWING NO.  
SH 12 OF 34

**STREET CONSTRUCTION NOTES:**

- 1 SAWCUT AND REMOVE 1" WIDE (MIN.) PORTION OF EXISTING PAVEMENT.
- 2 CONSTRUCT 5" A.C. OVER 8" A.B.
- 3 GRIND EXISTING A.C. AND OVERLAY (1.5" MIN)
- 4 CONSTRUCT CONCRETE CURB & GUTTER TYPE B PER CITY OF CORONA STD. NO. 136.
- 4A CONSTRUCT 6" TO 8" CONCRETE CURB & GUTTER PER CITY OF CORONA STD. NO. 136 & 135.
- 5 CONSTRUCT CONCRETE SIDEWALK PER CITY OF CORONA STD. NO. 142 (WIDTH PER PLAN).
- 6 CONSTRUCT MODIFIED CONCRETE RESIDENTIAL DRIVEWAY APPROACH PER CITY STD. NO. 128 AND PER DETAIL SHOWN ON SHEET 3. (T=6")
- 6A CONSTRUCT MODIFIED CONCRETE DRIVEWAY APPROACH PER CITY STD. NO. 130 AND DETAIL ON SHEET 3. (T=6")
- 7 CONSTRUCT MODIFIED CONCRETE COMMERCIAL DRIVEWAY APPROACH PER CITY STD. NO. 131 AND DETAIL ON SHEET 3.
- 8 ADJUST WATER METER BOX TO GRADE
- 9 REMOVE AND DISPOSE OF EXISTING TREE (<24" DIA.)
- 9A REMOVE AND DISPOSE OF EXISTING TREE (≥24" DIA.)
- 10 ADJUST WATER VALVE COVER TO GRADE
- 11 REMOVE AND DISPOSE EXISTING CONCRETE DRIVEWAY AND DRIVEWAY APPROACH
- 11A REMOVE AND DISPOSE EXISTING AC DRIVEWAY AND DRIVEWAY APPROACH
- 12 REMOVE AND DISPOSE EXISTING STORM DRAIN PIPE (SIZE AND MATERIAL VARIES)
- 13 REMOVE AND DISPOSE EXISTING AC BERM
- 14 EXISTING CATHODIC PROTECTION TEST STATION TO BE RELOCATED BEHIND CURB AS DIRECTED BY CITY PER CITY STD. 454
- 15 REMOVE & DISPOSE EXISTING RETAINING WALL, FENCE, FOUNDATION, AND COLUMNS. (LENGTH AS NOTED)
- 16 CONSTRUCT TRUNCATED DOMES IN ACCORDANCE WITH THE LATEST ADA EDITION
- 17 ADJUST EXISTING STREET LIGHTING PULL BOX TO GRADE
- 18 EXTEND EXISTING FIRE HYDRANT LATERAL BEHIND CURB PER CITY STD. 412
- 19 INSTALL NEW STREET SIGN PER CITY STANDARD 512
- 20 ADJUST EXISTING UTILITY BOXES BY OTHERS
- 21 RELOCATE EXISTING STREET LIGHT & CONSTRUCT NEW FOUNDATION PER CITY STD. 503
- 22 CONSTRUCT SIDEWALK AROUND OBSTRUCTION PER CITY STD. 144
- 23 RELOCATE MAILBOX PER CITY STD. 709 BEHIND CURB FACE IN KIND
- 24 RELOCATE MAILBOX ON NEW POST PER CITY STD. 709
- 25 RELOCATE EXISTING DRIVEWAY LIGHTS IN KIND (INCLUDING COLUMNS, CONDUITS, AND ELECTRICAL)
- 26 RELOCATE SIGN AND POST PER CITY STD. 519, SIGN SP4-1(CA) SCHOOL SPEED LIMIT ASSEMBLY C
- 27 REMOVE AND REPLACE STREET LIGHTING PULL BOX PER CITY STD. 505
- 28 REPLACE WATER METER BOX PER CITY STD. 414
- 29 REMOVE AND RELOCATE EXISTING CONFLICTING PORTION OF VINYL FENCE
- 30 INSTALL RETAINING CURB FOR RAMPS (6" CURB MAX)
- 31 CONSTRUCT CONCRETE PAVEMENT AND CURB AS NOTED FOR RESIDENTIAL DRIVEWAY - (T=6")
- 32 CONSTRUCT AC PAVEMENT AS NOTED RESIDENTIAL DRIVEWAY - (T=6")
- 33 INSTALL NEW CONDUITS FOR RELOCATED STREET LIGHT POLES PER STD. 503 & 505

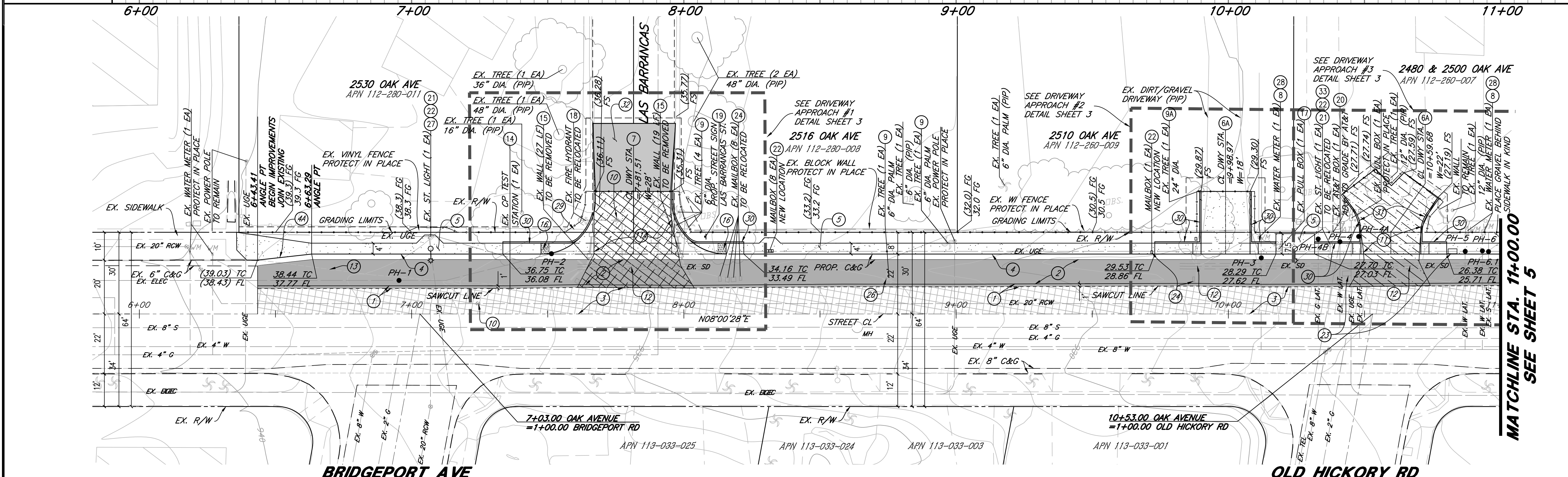
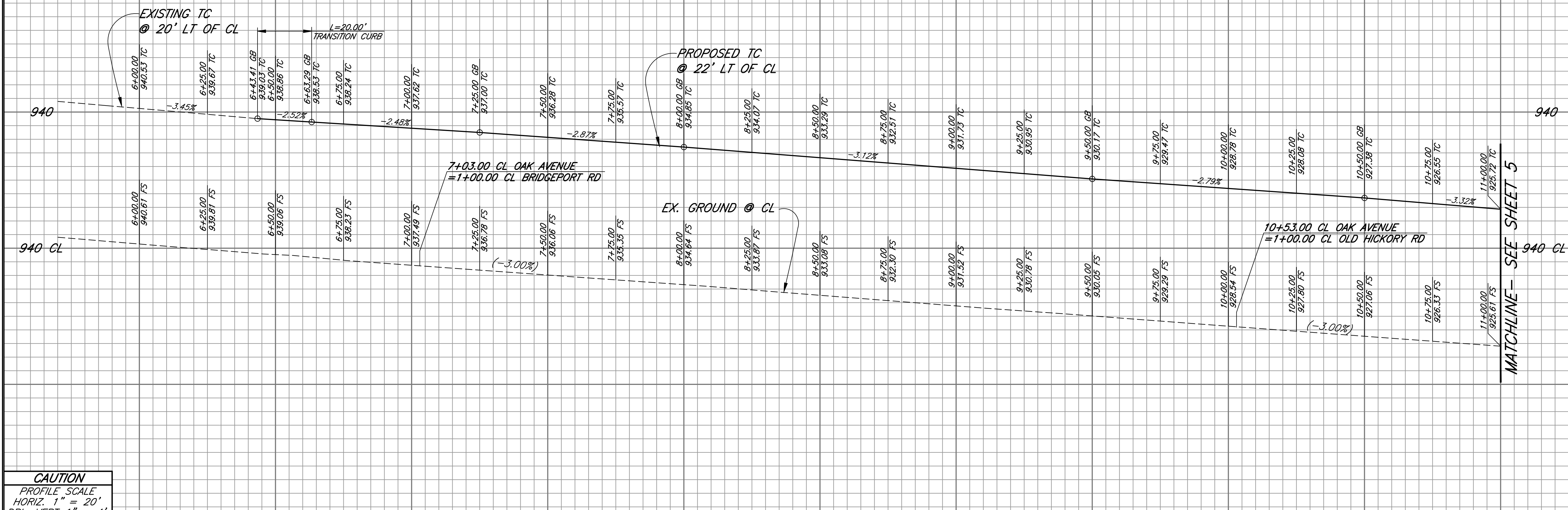

**CAUTION**  
PROFILE SCALE  
HORIZ. 1" = 20'  
DBL. VERT 1" = 4'

**POTHOLE SUMMARY TABLE**

PH #	UTILITY	TOP	BOTTOM	SIZE	TYPE
1	ELEC.	933.29'	932.79'	6"	PVC
2	ELEC.	930.89'	930.39'	6"	PVC
3	WTR. LAT.	925.29'	925.01'	1"	WRAPPED
4	SEWER LAT.	925.29'	924.96'	4"	PVC
4A	COMM.	925.67'	925.50'	2"	UNKNOWN
4B	GAS	925.84'	925.80'	0.5"	POLYETHYLENE

**POTHOLE SUMMARY TABLE**

PH #	UTILITY	TOP	BOTTOM	SIZE	TYPE
5	WTR. LAT.	922.31'	922.23'	1"	COPPER
5	ELEC.	918.49'	917.99'	6"	PVC
6	WTR. LAT.	923.81'	923.73'	1"	COPPER
6.1	SEWER LAT.	922.18'	921.85"	4"	PVC

**OAK AVENUE**

**NOTICE TO CONTRACTOR:**

1. CONTRACTOR TO VERIFY EXISTING STREET LIGHT CONDUIT, TRAFFIC SIGNAL CONDUITS, AND ANY DRY UTILITIES LOCATIONS AT STREET INTERSECTIONS PRIOR TO CONSTRUCTION.
2. CONTRACTOR SHALL PROTECT ALL EXISTING UTILITIES SHOWN OR NOT SHOWN ON THE PLANS. THE CONTRACTOR SHALL PROVIDE STRUCTURAL SUPPORTS TO PROTECT ALL EXISTING FACILITIES WHEN REQUIRED.
3. CONTRACTOR SHALL RE-STRIPE REMOVED PAVEMENT STRIPING, PAVEMENT MARKING, AND LEGENDS IN KIND, WHERE APPROPRIATE, AS DIRECTED BY CITY AT CONTRACTOR'S COST.
4. CONTRACTOR SHALL TRIM BUSHES & TREES ALONG R/W ADJACENT TO PRIVATE PROPERTY WHERE ENCROACHMENT OCCURS AS DIRECTED BY CITY AT CONTRACTOR'S COST.
5. CONTRACTOR SHALL REMOVE & CAP IRRIGATION LINES WHERE CONFLICTING WITH NEW IMPROVEMENTS.

**DRY UTILITY NOTE:**  
CONTRACTOR TO PROTECT EXISTING UNDERGROUND CONDUITS IN PLACE UNLESS NOTED OTHERWISE ON STREET PLANS.

NOTE:  
ADD 900 FEET TO ALL TWO DIGIT ELEVATION STARTING AT ZERO TO OBTAIN CURRENT DATUM. (I.E. 20.00 TO 925.00)

**LEGEND:**

- PROPOSED A.C.
- COLDMILL & OVERLAY
- CONCRETE P.V.M.T. REMOVAL
- AC P.V.M.T. REMOVAL
- CONCRETE PAVEMENT

**Underground Service Alert**  
Call: TOLL FREE  
**811**  
TWO WORKING DAYS BEFORE YOU DIG

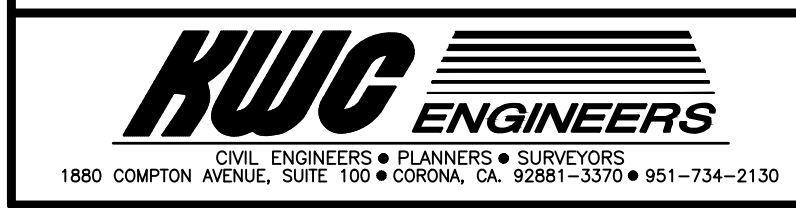
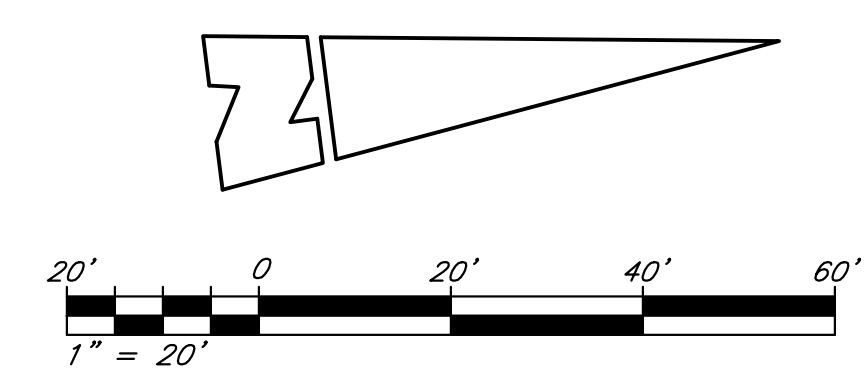

Designed by MCT  
Drawn by HC  
Checked by MCT  
PLANS PREPARED UNDER SUPERVISION OF  
Date MIKE C. TAING No. 64263

SEE SHEET 1  
Reference Plans for these Improvements  
Date By REVISIONS App'd

BENCH MARK  
C-126: ELEV. 960.047'  
SEE DESCRIPTION ON SHEET 1  
Scale AS NOTED

Approved By: Vernon R. Weisman, P.E.  
District Engineer  
R.C.E. No. 41610

Approved By: Savat Khamphou, P.E.  
City Engineer  
R.C.E. No. 62019

**CITY OF CORONA**  
**OAK AVENUE STREET AND SIDEWALK IMPROVEMENTS**  
PLAN AND PROFILE STA. 6+13.00 TO STA. 11+00.00

Drawing No. 4 of 7