

PRIMARY & PRIMARY INTERSECTION

ALWAYS LOCATE STREET NAME SIGN ON APPROACHING NEAR SIDE OF NORTHEAST CORNER AND SOUTHWEST CORNER. EXCEPTIONS AS APPROVED BY PUBLIC WORKS DIRECTOR.

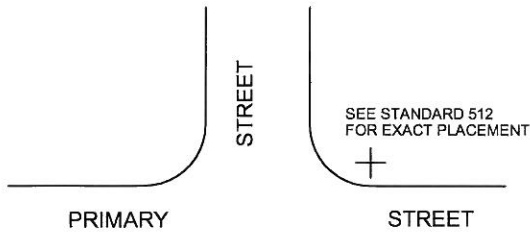

PRIMARY & SECONDARY INTERSECTION

ALWAYS LOCATE STREET NAME SIGN ON APPROACHING NEAR SIDE OF PRIMARY STREET REGARDLESS OF STREET DIRECTION. EXCEPTIONS AS APPROVED BY PUBLIC WORKS DIRECTOR.

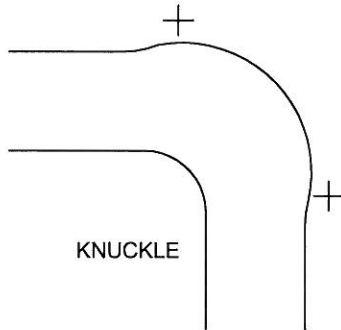
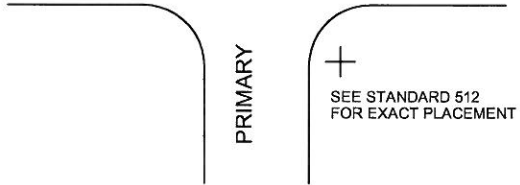
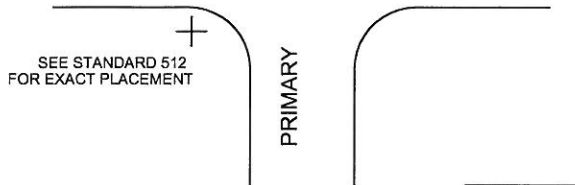
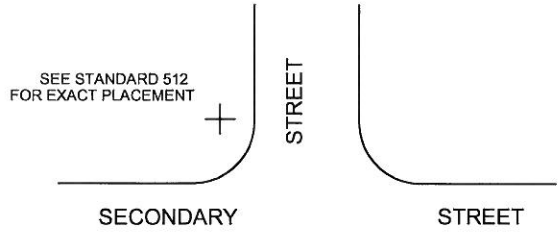

SECONDARY & SECONDARY INTERSECTION

ALWAYS LOCATE STREET NAME SIGN ON APPROACHING NEAR SIDE OF NORTHEAST CORNER. EXCEPTIONS AS APPROVED BY PUBLIC WORKS DIRECTOR.

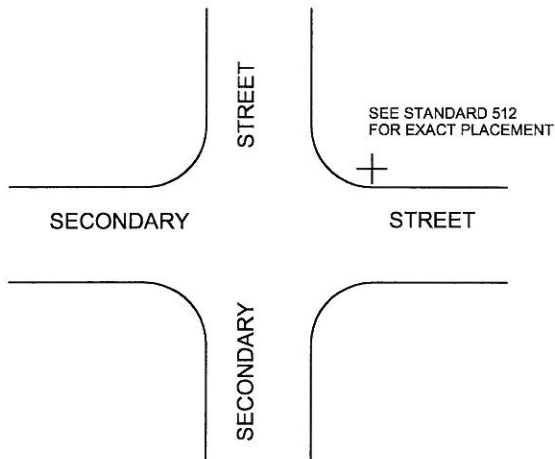

"T" INTERSECTIONS

ALWAYS LOCATE STREET NAME SIGN ON APPROACHING NEAR SIDE OF THROUGH STREET. EXCEPTIONS AS APPROVED BY PUBLIC WORKS DIRECTOR.

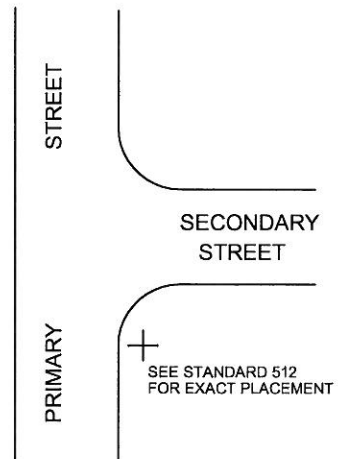

THE TERMS "PRIMARY" AND "SECONDARY" STREETS ARE INTENDED TO DENOTE WHICH STREET IS MORE IMPORTANT: E.G.: (THE WIDER STREET IS THE PRIMARY STREET)

PRIMARY	VS.	SECONDARY
ARTERIAL	VS.	COLLECTOR
COLLECTOR	VS.	LOCAL
LOCAL	VS.	CUL-DE-SAC

AT THE INTERSECTION OF 2 LOCAL STREETS, THE STREET CONSIDERED TO BE THE THROUGH STREET WILL BE BASED ON EXAMINATION OF NEIGHBORHOOD STREET PATTERNS BY THE FIELD ENGINEER.

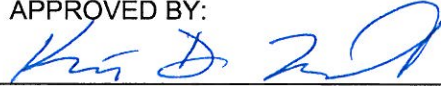
APPROVED BY:  
  
 11/23/09  
 CITY ENGINEER DATE  
 KIP D. FIELD

CITY OF CORONA

STREET NAME SIGN  
 LOCATION

REVISION	DESCRIPTION	BY	DATE

STANDARD PLAN NUMBER: **514** SHT 1 OF 1

