

PLAN

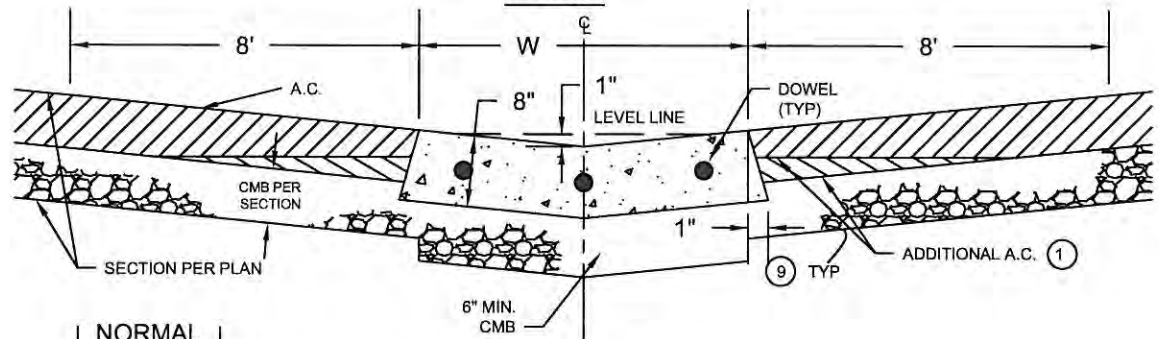

SECTION A-A

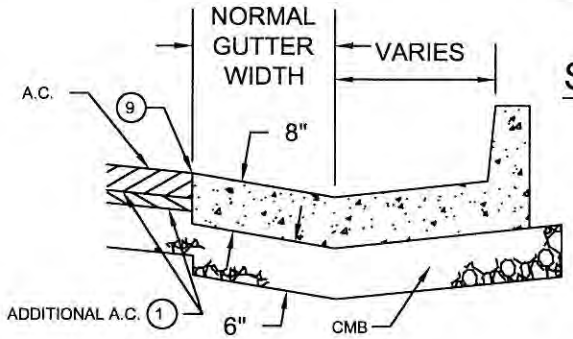

SECTION B-B

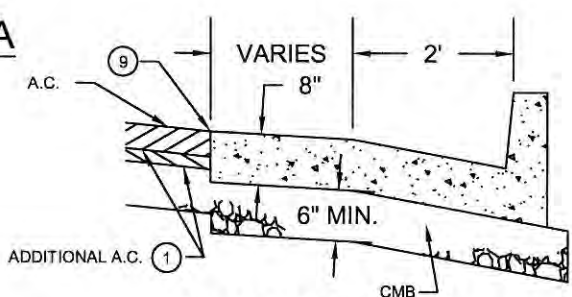

SECTION C-C

NOTES

1. THICKENED PAVEMENT CONSISTS OF SPECIFIED STREET SECTION + 2" AC AT CONCRETE TAPERING (8' WIDE).
2. CURB RETURN RADIUS SHALL BE PER PLAN.
3. CURB RETURN, SPANDRELS, AND GUTTER SHALL BE POURED MONOLITHIC.
4. OPTIONAL COLD JOINT OR WEAKENED PLAIN JOINT. PROVIDE 3 NO. 4 SMOOTH STEEL DOWELS, 4' LONG AT EACH LOCATION SHOWN.
5. 1/4" DEEP SCORE LINE.
6. MINIMUM 6" CMB REQUIRED UNDER ALL CONCRETE.
7. NORMAL SPANDREL WIDTH (W) IS 8'. OPTIONAL W=6' MAY BE USED ONLY WITH SPECIAL APPROVAL BY THE DIRECTOR OF PUBLIC WORKS.
8. CONCRETE TO BE CLASS 560-C-3250, 4" MANDATORY SLUMP.
9. ALL CONCRETE ABUTTING A.C. SHALL BE CONSTRUCTED WITH A 1" BATTER.
10. CROSS GUTTERS SHALL NOT BE PLACED ON COLLECTOR STREETS OR ABOVE.



APPROVED BY:
Kip D. Field
 11/23/09
 CITY ENGINEER DATE
 KIP D. FIELD

CITY OF CORONA
CROSS GUTTER AND SPANDREL

REVISION	DESCRIPTION	BY	DATE

STANDARD PLAN NUMBER: **145** SHT 1 OF 3

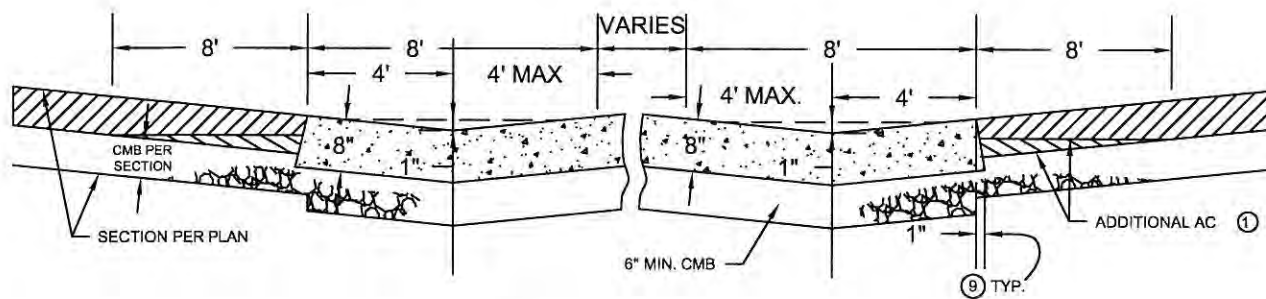
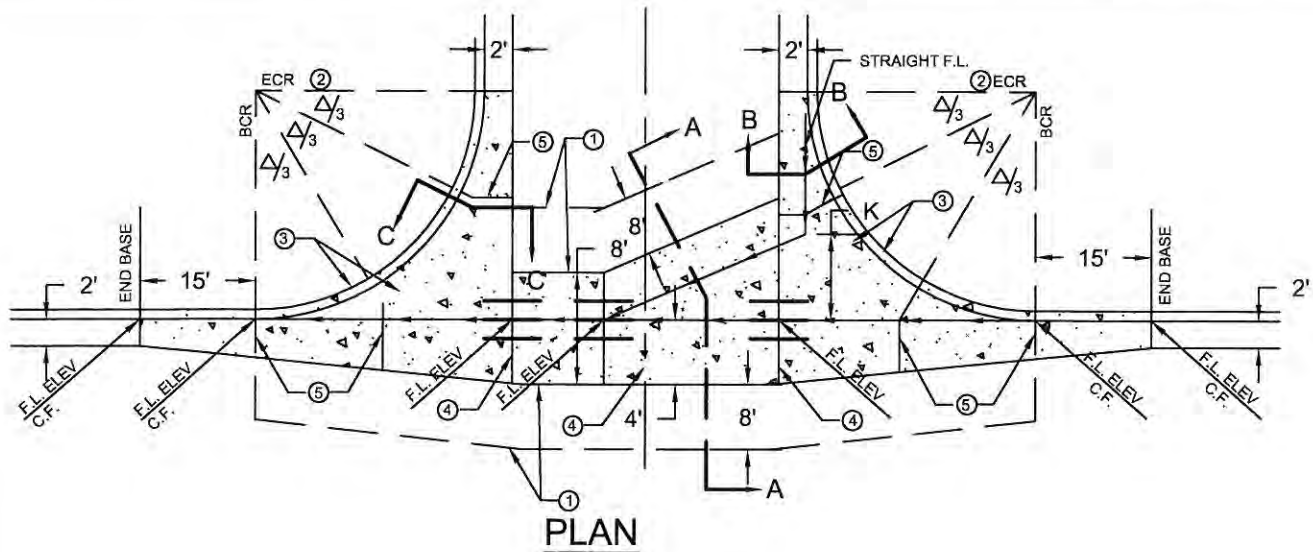

SECTION A-A

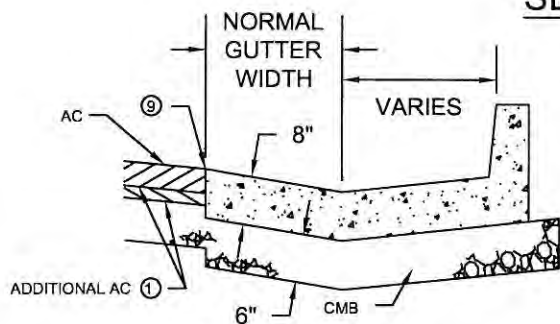

SECTION B-B

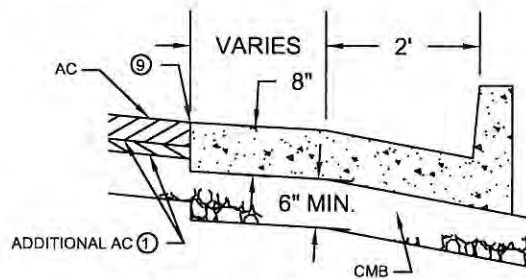

SECTION C-C

NOTES

1. THICKENED PAVEMENT CONSISTS OF SPECIFIED STREET SECTION + 2" AC AT CONCRETE TAPERING (8' WIDE).
2. CURB RETURN RADIUS SHALL BE PER PLAN.
3. CURB RETURN, SPANDRELS, AND GUTTER SHALL BE POURED MONOLITHIC.
4. OPTIONAL COLD JOINT OR WEAKENED PLAIN JOINT. PROVIDE 3 NO. 4 SMOOTH STEEL DOWELS, 4' LONG AT EACH LOCATION SHOWN.
5. 1/4" DEEP SCORE LINE.
6. MINIMUM 6" CMB REQUIRED UNDER ALL CONCRETE.
7. NORMAL SPANDREL WIDTH (W) IS 8'. OPTIONAL W=6' MAY BE USED ONLY WITH SPECIAL APPROVAL BY THE DIRECTOR OF PUBLIC WORKS.
8. CONCRETE TO BE CLASS 560-C-3250, 4" MAN. SLUMP.
9. ALL CONCRETE ABUTTING AC SHALL BE CONSTRUCTED WITH A 1" BATTER.
10. CROSS GUTTERS SHALL NOT BE PLACED ON COLLECTOR STREETS OR ABOVE.

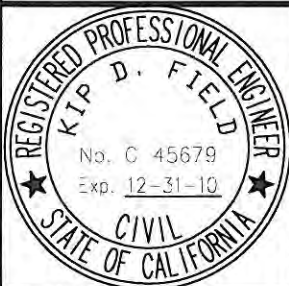

APPROVED BY:
Kip D. Field 11/23/09
 CITY ENGINEER DATE
 KIP D. FIELD

CITY OF CORONA

**SPECIAL CROSS GUTTER
 AND SPANDREL**

REVISION	DESCRIPTION	BY	DATE

STANDARD PLAN NUMBER: **145** SHT 2 OF 3

